

SANTA CRUZ II

GALAPAGOS CRUISE







CONTENTS

The Galapagos Iconic Islands Galapagos BIG15	pp. 6-19
The Santa Cruz II Deck Plans Cabins Lounges and Deck Spaces Cuisine The Expedition	pp. 20-51
Santa Cruz II Itineraries	pp. 52-61
Our People	pp. 62-63
Our Commitment to the Galapagos	pp. 65-66
Company Profile	pp. 68-69

Edition: July 2016



Dear Friends

At Metropolitan Touring, we're proud of our legacy as the pioneers of cruise travel in the Galapagos Islands. This heritage carries it with enormous responsibilities to protect this remarkable, generous, and unique environment that must under all circumstances be preserved and to share it with you, our guests, who entrust us with your expedition holiday of a lifetime.

Way back in 1969, our Lina-A became the first locally based cruise ship to ply the archipelago's waters. A decade later, we had the Santa Cruz custom built as an expedition vessel that set the standard for exploration of the islands. And last year, we bid the venerable Santa Cruz farewell, after an incredible legacy cruise that opened the eyes of 210 children, residents of Galapagos, to the beauty of their home in a way that many had never experienced before.

And with that fond farewell, it was time for the Santa Cruz II, the newest jewel in our fleet, to set sail on its maiden voyage. Its predecessor's highly experienced and passionate crew stayed on to continue providing stellar service, underpinned by a luxury 3:2 ratio of guests to staff. Guests will love the ample ship, designed according to Metropolitan Touring's unparalleled expertise. Easy to find your way around from the moment you board, it features large cabins and picture windows with flexible accommodation arrangements. Its generous, indulging lounges and outdoor deck areas ensure that everyone can find their own space for their journey. The itineraries, conceived to maximize Galapagos Big15 wildlife viewing opportunities, offer exclusive island visits at 99% of Galapagos National Park visitor sites, where guests disembark in small groups far below the average group size on most Galapagos vessels for a more personal experience. And of course, all of the options for Galapagos aquatic activities are available – glass-bottom boat, ocean kayak, and snorkelling. And starting in 2018, the itineraries get even better.

The Santa Cruz II, like her sister ships in our trio of top-notch vessels, sets the gold standard for Galapagos cruise travel with fine dining, safety and security, and conservation as a key factor in its success. Her new facilities enable a fun-filled, educational adventure that will connect you with the archipelago's fabled wildlife like never before. We invite you to discover the Galapagos aboard the Santa Cruz II with us!

Paulina Burbano de Lara
Executive President
Metropolitan Touring

The Galapagos Islands

Without exaggeration, the Galapagos archipelago is a place like no other. Its islands emerged from the bottom of the sea in leviathan volcanic upheavals, the effects of which one can still observe today. Winds and competing ocean currents seeded life on this remote group of islands, creating the natural laboratory that compelled British naturalist Charles Darwin to develop his theories of evolution in the wake of his visit in 1835. His ideas shattered long-held basic concepts about life itself. Thanks to Ecuador's visionary creation of the Galapagos National Park in 1959, the islands may well be more pristine now than when Darwin walked their shores! From its namesake giant tortoises to dancing blue-footed boobies and albatross to marine iguanas – miniature aquatic dragons – to cavorting sea lions, the uniquely trusting wildlife of the Galapagos will look you in the eye just an arm's length away – connecting you to nature like nowhere else.





Landscapes without peer
The Galapagos Islands

Wolf Volcano, Isabela Island, Galapagos, May 2015

Wildlife without fear
The Galapagos Islands





Sea life, as you've never seen it before
The Galapagos Islands



Galapagos journeys cover great distances and reveal a wide scope of landscapes. Strong currents and deep waters lead to surprisingly great differences among the flora and fauna of individual islands, as Darwin already found more than 150 years ago. As he discovered, “the natural history of these islands is eminently curious, and well deserves attention.” This is truest for the quintessential Galapagos Big15 animal species and notable iconic islands. Backed by close to a half century of experience in the Galapagos, Metropolitan Touring will take you on voyages that balance each journey with an optimum combination of wildlife, geography, shore activities and wonderful service.



Iconic Islands

The far-flung archipelago consists of 19 islands – 13 large and 6 small – and dozens of islets and rocks that break the waterline, according to the Galapagos National Park. They dot a vast area of 45,000 square kilometres (17,000 square miles) on both sides of the equator. Shaped by eons of eruptions and lava flows, the islands are as varied as the unique animals that inhabit them. A full 97% of the islands is protected by the National Park, accessible only via a cruise. Explore volcanic craters, fascinating lava flows, forests of bizarre cacti or fragrant palo santo trees, barren deserts and beaches in all sorts of colours: white, black, red, or gold. If you've seen one Galapagos island, you haven't seen them all.

1. Bartolome Island
2. Española Island
3. Fernandina Island
4. Floreana Island
5. Genovesa Island
6. Isabela Island
7. North Seymour Island
8. Santa Cruz Island
9. Santa Fe Island

G A L A P A G O S
BIG 15
 METROPOLITAN TOURING

It's quite simple: The more iconic species you see on your visit to the Galapagos Islands, the more rewarding and memorable your experience will be!

When it comes to wild animal observation, no place on Earth compares to the Galapagos. Lumbering giant tortoises and curious sea lion pups amid the alien landscapes let you feel what it was like before humans emerged on the planet. But because of the vastness of the archipelago, deciding where to go and what to observe can be quite a challenge. To enable guests to experience the best balance of Galapagos wildlife, Metropolitan Touring sought consensus among scholars, our Naturalist Guides, and island connoisseurs to choose the archipelago's most unique and fascinating animals. Their analysis resulted in our list of the Galapagos Big15 that reveals the most iconic Galapagos species.

1. Galapagos Albatross
2. Blue-Footed Booby
3. Nazca Booby
4. Red-Footed Booby
5. Flightless Cormorant
6. American Flamingo
7. Frigatebirds
8. Galapagos Hawk
9. Land Iguana
10. Marine Iguana
11. Santa Fe Land Iguana
12. Galapagos Penguin
13. Galapagos Sea Lion
14. Galapagos Fur Seal
15. Galapagos Giant Tortoise





**Metropolitan Touring presents
the Santa Cruz II**



SANTA CRUZ II

GALAPAGOS CRUISE

Conceived for operations in remote areas, our **state-of-the-art expedition vessel** evinces the perfect infrastructure for Galapagos exploration. Carrying its crew's heritage of decades of experience working in the islands and just over 70 metres long, the generous, **five-deck craft holds 50 cabins for 90 guests** and features ample, luxury-sized social areas indoors and out that allow guests to make the most of their Galapagos cruise experience

SANTA CRUZ II

GALAPAGOS CRUISE

Santa Cruz II's modern, generous social areas, laid out with choice contemporary materials, feature prominently on four of its five decks. With an intelligent layout, including wide hallways and broad stairwells, guests will immediately know their way around. From dining areas indoors and out, the fitness room and hot tubs, to the elegant bar and lounge, not to forget the well-stocked library, the ship is designed to please with sophisticated simplicity. Each passenger will find their own special space as the ship offers one of the top 5 guest-space ratios of all Galapagos passenger vessels. **And the luxury 3:2 guest/crew ratio guarantees quality individual attention.**

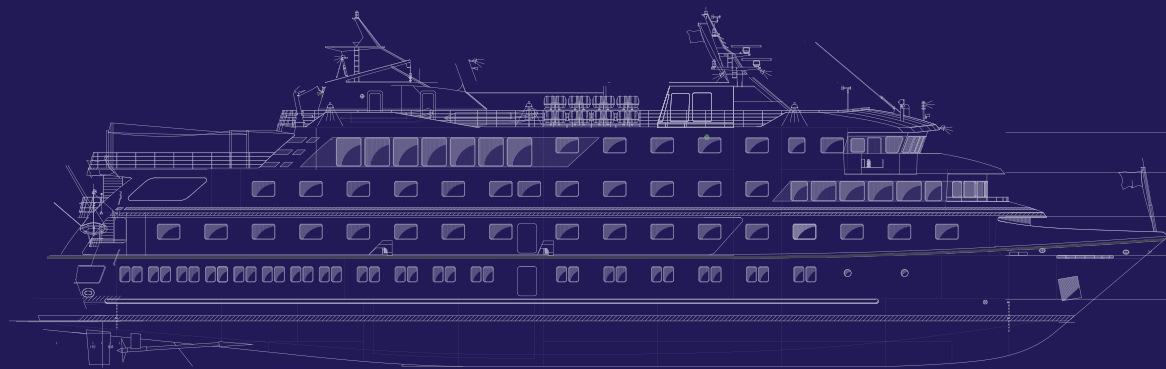

- SKY DECK
- PANORAMA DECK
- EXPEDITION DECK
- HORIZON DECK
- OCEAN DECK



Cabin Distribution

	Darwin Suite	Voyager Cabin	Explorer Cabin*	Explorer Family Cabin	Total Cabins	Interconnecting Cabins
Sky Deck						
Panorama Deck	3		3		6	6
Expedition Deck			17		17	12
Horizon Deck		2	23	2	27	18
Ocean Deck						
Total	3	2	43	2	50	36

Capacity: 90 guests/50 cabins

*Beds in most Explorer Cabins can be joined from twins to doubles.

Technical Specifications

Refurbishment	2015
Construction	2002
Gross Tonnage	2664 tonnes
Passenger Space Ratio	29.6
Type of Vessel	Expedition Vessel
Capacity	90 guests / 50 cabins
Length	71.8 metres/235 feet
Beam	13.4 metres/43 feet
Speed	10.5 knots
Electricity	440 V - 220 V - 110 V throughout ship
Engines	2 Cummins engines KTA 38 - MO of 850 HP each
Fire Detector	Fire detectors throughout
Life Jackets	In each cabin
Life Rafts	14 (27 passengers each)
Landing Boats	6
Owner	ETICA (METROPOLITAN TOURING)
Decks	5
Crew	60
Naturalist Guides	8 (Includes Expedition Leader)
Guest-Crew Ratio	1:5 (3 guests per 2 crew members)
Medical Officer	Permanently on board
Certifications	ABS, SOLAS 74, ISM, ISPS, MARPOL

Facilities & Amenities

- Bar and Lounge
- Restaurant
- Outdoor terrace / BBQ
- Gift shop
- Fitness Room
- Reading room and natural history library
- Multiple purpose room
- Hot tubs (2)
- Air conditioned throughout
- Satellite telephone
- PA system
- Wi-Fi hotspot (intermittent/ low bandwidth connection)
- 24/7 coffee station (free coffee, tea, and water)
- iPod/MP3 docking station
- Safe deposit box (in cabin)
- Hair dryer
- Snorkelling equipment
- Wetsuit rental
- Glass bottom boat
- Kayaks
- Pangas (inflatable dinghies for coastal exploration)

Sky Deck

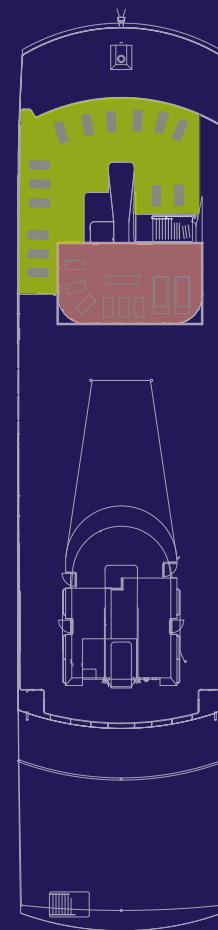

- Solarium/Sun Deck
- Fitness Room

Panorama Deck



- Panorama Veranda
- Bridge
- Darwin Suite
- Explorer Cabin
- Panorama Bar & Lounge
- Restrooms
- Outdoor Terrace

Expedition Deck



- Expedition Veranda
- Expedition Lounge & Library
- Explorer Cabin
- Discovery Room
- Hot Tubs

Horizon Deck

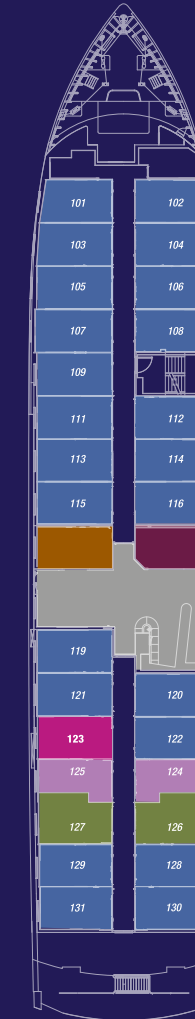

- Explorer Cabin
- Gift Shop
- Reception Area
- Restrooms
- Infirmary
- Voyager Cabin
- Explorer Family Cabin

Ocean Deck

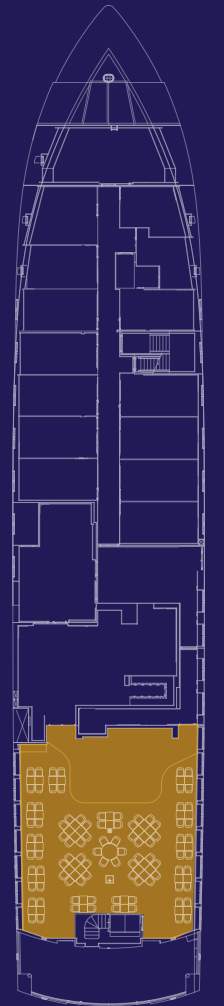

- Beagle Restaurant



Explorer Cabins

The Santa Cruz II's Swedish-designed cabins **reflect the latest in cruise trends**. Comfortable spaces and large picture windows illuminate the interior spaces and allow guests to take in the views, offering elegant relaxation areas after a day of active exploring. The ship has 50 cabins for 90 guests. Families and groups benefit from the flexible design, which allows 36 of the cabins to be interconnected. Solo travellers can occupy a double room with a mere 15% surcharge, down from the Galapagos standard 100%. Explorer Cabins are located on the **Expedition, Horizon, and Panorama Decks**.

Explorer Cabin



163.2 sq ft / 15.2 m²

Cabin amenities and features:

- Air conditioning
- Picture window
- Hair dryer
- iPod/MP3 docking station
- Numerous electrical outlets
- Public address system
- In-room safe
- Reading lights
- Internet available for an additional fee

- 43 Explorer Cabins (163.2 sq ft / 15.2 m²)
- 2 Explorer Family Cabins (191.9 sq ft / 17.8 m²)
- 2 Voyager Cabins (127.0 sq ft / 11.8 m²)



Darwin Suites

Our three Darwin Suites on the Panorama Deck, each measuring 30 m² (325 sq ft) with double picture windows, **will provide superb comfort and deluxe amenities** for more discerning guests. Additionally, they can be interconnected with an Explorer double cabin to increase space by another 15 m² (163 sq ft).

Darwin Suites

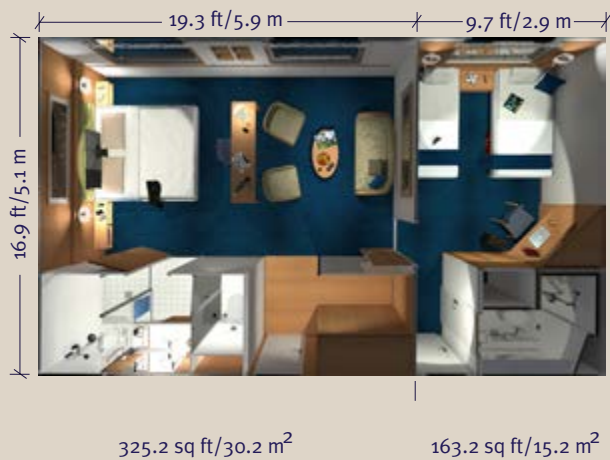

Suite amenities:

- Inset tablet in each suite
- L'Occitane-en-Provence amenities in bathrooms
- Bathrobes
- Deluxe extra pillows
- Special edition take-home coffee table book
- Air conditioning
- Large picture windows
- Hair dryer
- iPod/MP3 docking station
- Numerous electrical outlets
- Public address system
- In-room safe
- Reading lights
- Free Internet access*
- Wetsuit usage included
- Turn-down service delicacy
- In-cabin national & international magazines
- Expedition photos and videos on CD

*Some restrictions apply.



As a traveller, your ability to immerse yourself and connect with your destination is what will make your experience truly memorable.

Lounges and Deck Spaces

Indoors and out, the Santa Cruz II offers handsome installations that make the most of the Galapagos, ensuring your stay on board will perfectly complement the day's outings.

On the **Sky Deck**, guests can **relax and enjoy** the sun at the solarium/sun deck or exercise in the fitness room outfitted with treadmills.

On the **Panorama Deck**, guests can relish the equatorial outdoors on the aft terrace, which doubles as an area for enjoying a **barbeque snack**. The large bar/lounge offers a relaxing area to unwind amid the Santa Cruz's legendary convivial atmosphere. On the same deck, guests are also welcome to visit the modern bridge, featuring state-of-the-art electronic navigation equipment, run by our highly experienced captains.



Outdoor Terrace



Expedition Lounge & Library



Discovery Room



Fitness Room



Reception Area



Beagle Restaurant



Panorama Bar & Lounge



Panorama Veranda



Sun Deck



Hot Tub



Gift Shop

On the **Expedition Deck**, our guides will welcome you to an ample reading room and natural history library, with up-to-date technology for presentations on the geology, biology, and history of Darwin's famed "Laboratory of Evolution." **Facing the prow, it's a fantastic, calm place to view the beauty of the archipelago** in a climate-controlled environment. An open multi-purpose room on the deck's starboard side is available for children's programmes and other events. The aft features twin hot tubs.

On the **Horizon Deck**, besides Explorer cabins, you will find the gift shop, reception area and the infirmary, where a medical doctor is on call 24/7 (consultations are free of charge).

The Beagle Restaurant is located to the aft on the **Ocean Deck**.



Cuisine

We source as much of our food locally as possible – this means freshly caught fish and seafood and organically grown fresh vegetables and fruit, all prepared by a team passionate to provide sybaritic delights through Ecuadorean and international cuisine under the creative lead of our Gastronomic Director, a ***Le Cordon Bleu* chef**. Meals are served in the Beagle Dining Room and snacks are served after expeditions, whether in the bar, in the library or on the outdoor terrace, where you can take in the fabulous vistas and marine breezes of the Galapagos. A 24-hour coffee station located in the library provides free coffee, tea, and water.



Activities

The wonder experienced by Charles Darwin remains very much alive.
To live it will change the way you look at life.



Coastal Exploration, Fernandina Island

Galapagos: It's All About Fun, Discovery and Connection with Nature

One of the hallmarks of our voyages is our ability to explore the islands profoundly, just like Darwin did back in 1835 while aboard the HMS Beagle. It is through their power of observation that our Naturalist Guides reveal the uniqueness of this volcanic land, and **it is through our outings and landings that we unveil the secrets of our one Earth's most extraordinary wildlife destinations.** To design each day's excursions, our Expedition Leader adapts the archipelago's best offerings on site, translating his or her personal knowledge into a fantastic set of activities. When applied, these multiple sets of options will create guests' unforgettable Galapagos experiences. Some will include excursions on land, others will explore the aquatic realm, and others explore both.

Over the years, we have come to understand that the islands touch the souls of our guests through different experiences, and therefore **our vessel incorporates various enriching ways to explain the Galapagos.** Aquatic activities introduce you to the Marine Preserve, where sea lions frolic right in front of snorkellers and sharks become visible underneath the **glass bottom boat**. Pangas (dinghies) and kayaks take explorers to shore and along the spectacular volcanic coasts. And after dark, Naturalist Guides will delight guests by opening up the special equatorial skies, famous for showing constellations from both hemispheres.



Glass Bottom Boat



Sea Kayaking



Snorkelling



Galapagos exploration is best done in small, well-coordinated groups directed by an Expedition Leader. We are proud that the Santa Cruz II has an average ratio of just 11 guests per naturalist guide, while the Galapagos National Park policy permits 16:1. This enables us to tailor groups according to abilities and interests, as well as to languages beyond English and Spanish (German, French and Italian). Our groups are each led by a multilingual park-certified Naturalist Guide, whose ample knowledge will be essential to unlock the islands' secrets to visitors. Some guides are birdwatchers, others love the ocean, and others can make the stones talk. These seasoned individuals will broaden your understanding and appreciation for the destination, while their on-board natural-history lectures will enhance the educational value of each voyage.



The background of the entire page is a photograph of the Santa Cruz II ship at sunset. The ship is silhouetted against a bright, golden sky with scattered clouds. The sun is low on the horizon, creating a shimmering reflection on the water's surface. The ship's complex structure, including its masts and deck, is clearly visible in silhouette.

Santa Cruz II Top Features:

A vessel designed and built for wildlife exploration in remote areas

- Exclusive island visits: 99% of visitor **sites are not shared** with other vessels
- **Small groups:** On average, approximately 11 guests per guide versus 16 permitted by the National Park authorities
- Expedition expertise: Our itineraries, carefully planned by our on-staff specialists, provide the best opportunities to see **Galapagos Big15 wildlife** on each trip
- **All aquatic activities** authorised by the National Park: **Glass-bottom boat**, kayaks, snorkelling, swimming, and panga-based coastal exploration
- **Privacy:** One of the **top 5 Guest-Space Ratios** of all Galapagos passenger vessels (29.6:1) with numerous social areas for private contemplation, educational activities and socializing
- Separate lecture rooms: Available for **simultaneous presentations**
- Flexible accommodation arrangements: 90% of all cabins include convertible beds and **72% of cabins are interconnected**
- Service: **A guest/crew ratio of 3:2** provides the basis for an impeccable journey
- Fine dining: *A Le Cordon Bleu-educated* **gastronomy director**
- Health care: A well-equipped infirmary with a **Medical Officer (M.D.) on board (24/7)** offering consultations free of charge
- **Onboard photographer** available to support guests in their search for the best photographic memory of their journey.
- **Environmentally responsible:** Modern engine technology for lower fuel consumption, on-board water production (desalination plant) and water treatment plant to reduce each guest's environmental impact

Itineraries

From the remote but wildlife-filled corners of the archipelago – Española, Fernandina, and Genovesa – to the landmarks of the Central Islands, the Santa Cruz II's itineraries take in the length and breadth of the Galapagos. Tailored to **view as many of the islands' Galapagos Big15 as possible while meeting National Park rules**, all options provide explorers with a safe, active, fun, and educational experience. All include sea lions, marine iguanas, and giant tortoises. Use the chart below the map to see how many of the Galapagos Big15 you will see on each journey.

Combining the Eastern and Western Itineraries will allow visitors to see all of them!



Newly-hatched Sea Turtle, Sullivan Bay

SANTA CRUZ II

GALAPAGOS CRUISE

	ROUTE
5D-4N ITINERARY E ASTERN GALAPAGOS SATURDAY TO WEDNESDAY SAN CRISTÓBAL - BALTRA	-----
6D-5N ITINERARY W ESTERN GALAPAGOS WEDNESDAY TO MONDAY BALTRA - BALTRA	—————
5D-4N ITINERARY N ORTHERN GALAPAGOS MONDAY TO FRIDAY BALTRA - SAN CRISTÓBAL	- - - - -



GALAPAGOS BIG15

E	•	•	•	•	•	•	•	•	•	•	•	•	•	•	•	E 11/15
W		•	•	•	•	•	•	•	•	•	•	•	•	•	•	W 12/15
N		•	•	•	•	•	•	•	•	•	•	•	•	•	•	N 11/15
E+W	•	•	•	•	•	•	•	•	•	•	•	•	•	•	•	E+W 15/15

Itineraries

7 DAYS / 6 NIGHTS Eastern

	AM VISITS	ISLAND	Aquatic Activities	PM VISITS	ISLAND	Aquatic Activities	Highlight
Friday	Puerto Baquerizo Moreno	San Cristobal		Punta Pitt	San Cristobal	  	Española
Saturday	Santa Fe	Santa Fe	 	South Plaza	South Plaza		
Sunday	Charles Darwin Research Station	Santa Cruz		Optional activities	Santa Cruz		
Monday	Punta Suarez	Española		Gardner Bay	Española	  	
Tuesday	Baltra Airport	Baltra					





5 DAYS / 4 NIGHTS Northern

	AM VISITS	ISLAND	Aquatic Activities	PM VISITS	ISLAND	Aquatic Activities	Highlight
Monday	Baltra Airport	Baltra		Las Bachas	Santa Cruz	  	Genovesa
Tuesday	Buccaneer Cove	Santiago	 	Puerto Egas	Santiago	 	
Wednesday	Red Beach	Rabida	 	Bartolome	Bartolome	  	
Thursday	Prince Philip's Steps	Genovesa		Darwin Bay	Genovesa	  	
Friday	Puerto Baquerizo Moreno Tortoise Breeding Centre	San Cristobal					

Itineraries for reference only. Our route and programmes may vary according to National Park policies and regulations, weather conditions, seasonal changes, safety & operational reasons and the wildlife we encounter.

Aquatic activities:  Snorkel  Panga Ride  Kayak  Glass-bottom boat  Beach  Swim

5 DAYS / 4 NIGHTS Western

	AM VISITS	ISLAND	Aquatic Activities	PM VISITS	ISLAND	Aquatic Activities	Highlight
Wednesday	Baltra Airport	Baltra		North Seymour	North Seymour		North Seymour Fernandina
Thursday	Punta Vicente Roca	Isabela	 	Punta Espinoza	Fernandina		
Friday	Tagus Cove	Isabela	  	Urbina Bay	Isabela	  	
Saturday	Charles Darwin Research Station	Santa Cruz		Optional activities	Santa Cruz		
Sunday	Post Office Bay	Floreana	  	Champion Islet & Punta Cormorant	Floreana	  	
Monday	Baltra Airport	Baltra					

Important notes

Our itineraries include:

- Transportation to/from the airport in Galapagos
- Accommodation
- All meals while on board
- Bilingual naturalist guides
- Conferences and lectures
- Island excursions and activities
- Snorkelling equipment
- Kayaks
- Glass bottom boat

Not included:

- Airfare to/from Galapagos
- Galapagos National Park entrance fee and immigration control card
- Beverages and tips
- Wetsuit rental
- Internet service*

*Due to the remote location, Internet connections are intermittent and low-bandwidth.



Our People

Metropolitan Touring's achievements over its more than **six decades of operations** in Ecuador and the Galapagos Islands are rooted in the people who make up the company. **Service is our passion and teamwork is key.** We are nature-lovers, people who adore the great outdoors.

We love to explore and to push ourselves. Our knowledgeable Naturalist Guides and Expedition Leaders deserve special mention.

Our team includes an amazing range of enthusiastic specialists and captivating communicators, whether they are biologists, historians, birdwatchers, chefs, marine experts, sailors, doctors, captains or experts in their chosen field.



Lava Cactus - Fernandina Island

Our commitment to the Galapagos

As pioneers in exploring the Galapagos Islands, we take the preservation of the National Park and Marine Reserve very seriously. Not only do we follow local regulations and international standards to the letter; our connection with the Galapagos goes back as far back as 1969, when we helped to establish respectful, yet educational visiting practices. These rules are seen today in many nature preserves worldwide, where environmental interpretation is required to enhance the destination. Modern terminology has coined this attitude in words such as ecotourism, sustainable tourism, nature tourism, etc. For us, this is a matter of understanding the fragility of the islands and our role as responsible operators.

Because the human impact is undeniable, we found our niche in contributing to the improvement of the islands' wellbeing. After careful review of the equation, we came to the conclusion that the presence of human beings on the islands – both of residents and of visitors – could result in a potential hazard unless something was done about it. Thus, in 1989, we created Fundación Galapagos-Ecuador that created projects targeting pollution in the islands. **Its greatest success was the in-depth modernisation of the solid-waste management system on Santa Cruz Island**, including recycling, classification, education, and the provision of options for the local community. In 2014, having accomplished its mission, this project was donated to the local authorities on the island.

Company profile

Metropolitan Touring is a proudly regional Destination Management Company, with its own offices and operations in Ecuador, Peru, and Colombia.

Almost five decades ago, **we pioneered Galapagos Expedition Travel**. In the Galapagos, Metropolitan Touring owns and operates the Finch Bay Eco Hotel, the only beachfront property on Santa Cruz Island, as well as a trio of expedition vessels: our new Santa Cruz II as well as Yachts Isabela II and La Pinta. Our holding group includes luxury hotels Casa Gangotena in the historic old town of Quito and Mashpi Lodge in Ecuador's Chocó rainforest.

We have a special place in our hearts for nature, unique locations and extraordinary service. We know and love our countries. We create inspiring journeys across South America for our guests, each one a story in the making.





PRODUCTION TEAM

Credits: Metropolitan Touring

Photography: Image Bank MT, Galapagos Expedition Staff, Lucas Bustamante, Pg 5, EP Magazine



Av. De las Palmeras N45-74 y De las Orquídeas, Quito - ECUADOR

Tel.: (593-2) 298 - 8300 | Fax: (593-2) 334 - 1250

www.metropolitan-touring.com | info@metropolitan-touring.com

www.santacruzgalapagoscruise.com